

UPDATE

6/26/03

This package provides a new scanner product section to be added to the *EPSON Product Information Guide*. The table of contents of this section is listed below.

**EPSON Perfection® 1670 Photo**

TABLE OF CONTENTS

Scanner Parts .....	EPSON Perfection 1670 Photo - 1
Scanner Specifications .....	EPSON Perfection 1670 Photo - 1
AC Adapter Specifications .....	EPSON Perfection 1670 Photo - 2
Film Adapter Specifications .....	EPSON Perfection 1670 Photo - 2
Unlocking the Scanner .....	EPSON Perfection 1670 Photo - 2
Scanner Buttons .....	EPSON Perfection 1670 Photo - 3
Scanner Light .....	EPSON Perfection 1670 Photo - 3
Using EPSON Smart Panel .....	EPSON Perfection 1670 Photo - 3
Selecting the Scanning Mode in EPSON Scan .....	EPSON Perfection 1670 Photo - 4
Restoring Color in Photos .....	EPSON Perfection 1670 Photo - 4
Placing Film on the Scanner .....	EPSON Perfection 1670 Photo - 5
Transporting the Scanner .....	EPSON Perfection 1670 Photo - 6
Related Documentation.....	EPSON Perfection 1670 Photo - 6

## Scanner Parts

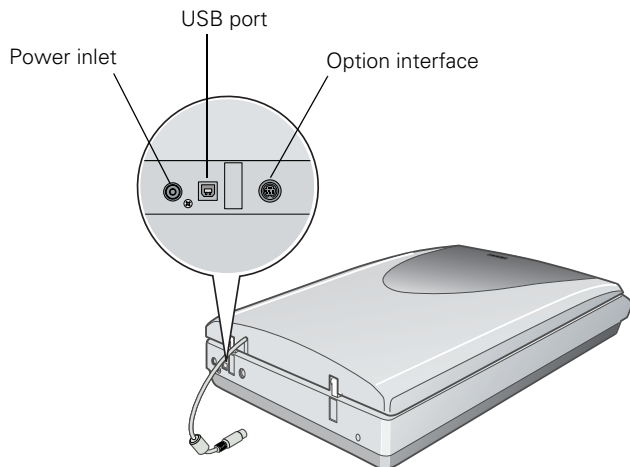
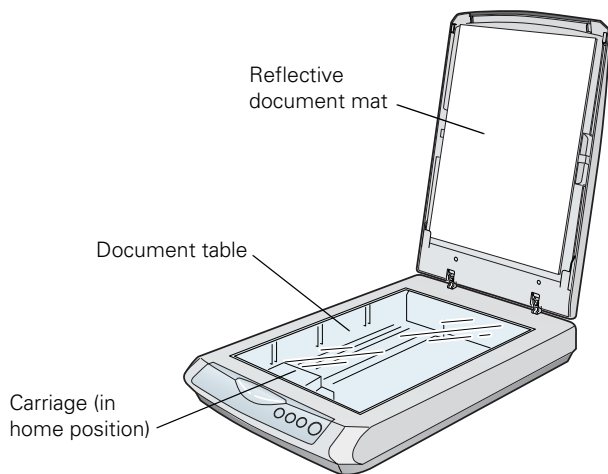
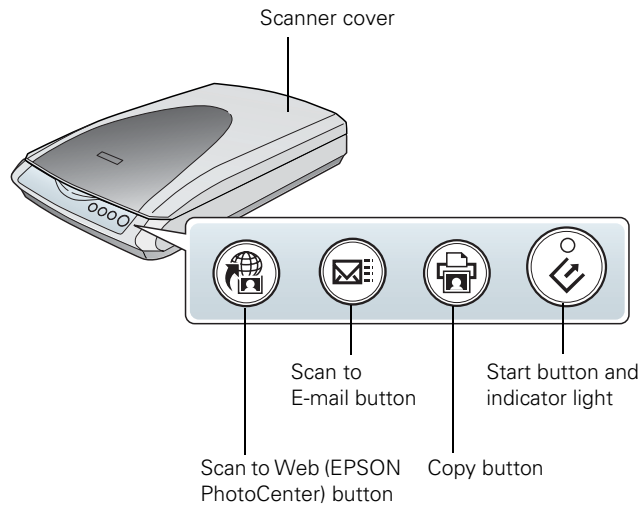

The EPSON Perfection 1670 Photo also comes with a holder for 35 mm film and slides.

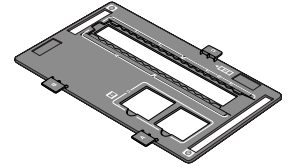

## Scanner Specifications

### Basic Specifications

Scanner type	Flatbed, color
Photoelectric device	Color CCD line sensor
Effective pixels	13600 × 18720 pixels at 1600 dpi, 100% scaling
Maximum document size	US letter or A4 size (8.5 × 11.7 inches [216 × 297 mm]); the reading area can be specified from your software
Scanning resolution	1600 dpi (main scan); 3200 dpi with sub scan resolution*
Output resolution	50 to 12,800 dpi (50 to 6400 dpi in 1 dpi increments; 12,800 dpi performed with zoom function)
Scanning speed	7.68 msec/line at 1600 dpi (A4) 5.12 msec/line at 600 dpi (A4)
Color separation	RGB color filters on CCD
Pixel depth	16 bits per pixel per color internal 1, 8, 16 bits per pixel per color external
Line art settings	Fixed threshold
Digital halftoning	AAS (Auto Area Segmentation), enable/disable selectable 3 error diffusion modes (A, B, and C) and 4 dither patterns (A, B, C, and D) for bi-level and quad-level data
Gamma correction	1 type for user-defined
Color correction	1 type for user-defined (only user-defined color correction is available in EPSON Scan)
Interface	USB 2.0 (Type B receptacle connector)
Light source	White cold cathode fluorescent lamp
Reliability	10,000 cycles of carriage movements (main unit MCBF)

\* The maximum hardware resolution of 1600 × 3200 dpi is achieved using EPSON's Micro Step Drive™ technology.

Dimensions      Width: 10.8 inches (275 mm)  
                          Depth: 16.5 inches (419 mm)  
                          Height: 3.4 inches (86 mm)

Weight            Approx. 6.8 lb (3.0 kg)

## Electrical

Input voltage range      AC 100 to 120 V  
 Rated frequency        50 to 60 Hz  
 Rated input current      0.5 A  
 Power consumption      17 W (operating mode),  
                                   15 W (standby mode, 5.5 W sleep mode)

Note: Check the label on the back of the scanner for voltage information.

## Environmental

Temperature            Operation: 41 to 95 °F (5 to 35 °C)  
                                  Storage: -13 to 140 °F (-25 to 60 °C)

Humidity (without condensation)      Operation: 10% to 80%  
                                  Storage: 10% to 85%

Operating conditions      Ordinary office or home conditions; avoid extreme dust, direct sunlight, and strong light sources.

## Approvals

Safety                  UL 1950  
                                  CSA C22.2 950

EMC                     FCC part 15 subpart B class B  
                                  CSA C108.8 class B

## USB Interface

Interface type          Universal Serial Bus Specification  
                                  Revision 2.0

Electrical                Full Speed mode: 12 Mbit/s,  
                                  Hi-speed mode: 480 Mbit/s,  
                                  Universal standard Serial Bus Specification  
                                  Revision 2.0

Connector type        One receptacle (Type B)

## Option Interface Connector

Output voltage        15.2 V; 50 to 60 Hz

## Initialization Methods

The scanner can be initialized (returned to a fixed set of conditions) in the following ways:

Hardware initialization	<input type="checkbox"/> The scanner is plugged in. <input type="checkbox"/> The USB cable is unplugged from the USB port on the scanner.
Software initialization	<input type="checkbox"/> Software sends the ESC @ (initialize the scanner) command. <input type="checkbox"/> The scanner receives a Bus Reset from the USB interface.

## AC Adapter Specifications

Rated input              AC 100 to 120 V, 50 to 60 Hz  
 Rated output            DC 15.2 V, 1.2 A  
 Temperature            Operation: 41 to 95 °F (5 to 35 °C)  
 Safety                    UL 1950 or UL60950  
                                  CSA C22.2

EMC                      FCC part 15 subpart B class B  
                                  CSA C108.8 class B

## Film Adapter Specifications

Electrical                Supplied voltage: DC 15.2V  
                                  Rated current: 0.3 A

Transparencies size    35-mm film strip 3 frames  
                                  35-mm slide, 2 frames

Readable area            1.9 × 4.9 inches (49 × 125 mm)

## Unlocking the Scanner

Be sure to unlock the scanner before using it. Slide the transportation lock to the unlock position:

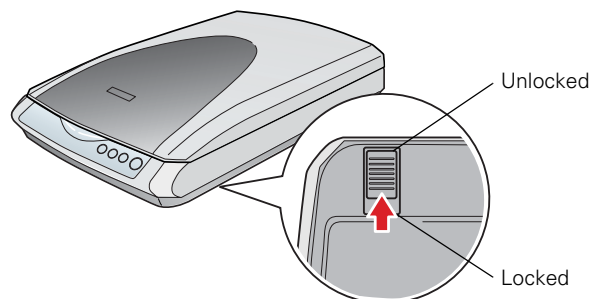

If you need to transport the scanner, see page 6.

## Scanner Buttons

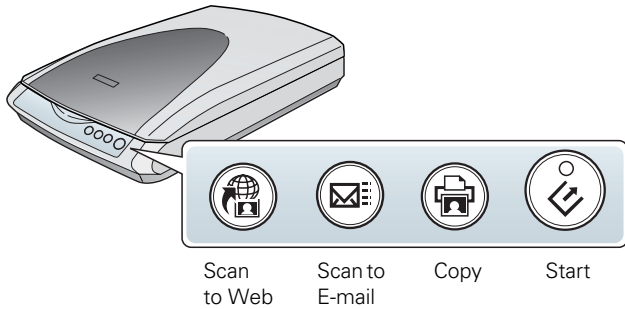

The scanner's buttons let you perform one-touch scanning with EPSON Smart Panel.™

	Press the  Start button on the scanner to start EPSON Smart Panel (default).
	Press the  Copy button to automatically scan and print an image.
	Press the  E-mail button to scan your image and send it as an e-mail attachment.
	Press the  Scan to Web button to scan an image and upload it to the EPSON photo-sharing site, EPSON PhotoCenter.™

## Scanner Light

The scanner has one indicator light (on the Start button), which indicates the status of the scanner.

Light	Color	Status
On	Green	The scanner is ready to scan images.
Flashing	Green	The scanner is initializing or is busy scanning.
Flashing	Red	The transportation lock may not be released. Unlock the scanner, then restart your computer. If this does not eliminate the error, one of the following may be the problem and you need to consult your dealer or EPSON: <ul style="list-style-type: none"> <li><input type="checkbox"/> The fluorescent lamp needs to be replaced.</li> <li><input type="checkbox"/> The scanner is malfunctioning.</li> </ul>
Off	—	The scanner is off or the AC adapter is unplugged.

## Using EPSON Smart Panel

Follow these steps to use EPSON Smart Panel to scan documents or photos:

1. Place the original document(s) face down on the document table.

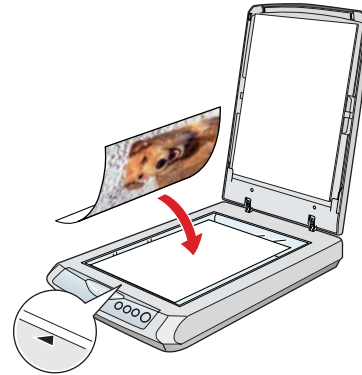

2. Do one of the following to open the Smart Panel:
  - Press the Start button on your scanner.
  - Click the EPSON Smart Panel icon on the desktop.
  - On a Macintosh,® you can also open the Apple® menu and select EPSON SMART PANEL.



The Start button is set to open EPSON Smart Panel by default. However, you can assign the Start button to automatically open any of the Smart Panel applications.

3. Click the icon for your desired scanning application. The window for that option appears and lets you adjust settings for your scan. Follow the on-screen steps for each option.



Keep the following in mind when using Smart Panel:

- ❑ If you select **Reprint Photos** or **Copy Center**, make sure your printer is turned on and the correct paper type and size is loaded in your printer.
- ❑ Scan to E-mail requires a MAPI-compliant e-mail program (AOL is not MAPI compliant).

For instructions on using each of the Smart Panel applications, click ? on the Smart Panel screen or see the electronic manual for EPSON Smart Panel.

## Selecting the Scanning Mode in EPSON Scan

EPSON Scan provides three scanning modes:

- ❑ Full Auto Mode allows the software to automatically select the best settings for your scan.
- ❑ Home Mode lets you adjust some of the basic settings before you scan.
- ❑ Professional Mode gives the greatest control over individual settings. You can sharpen, correct, or enhance your images before scanning.

Choose the scanning mode from the pull-down list at the top of the window

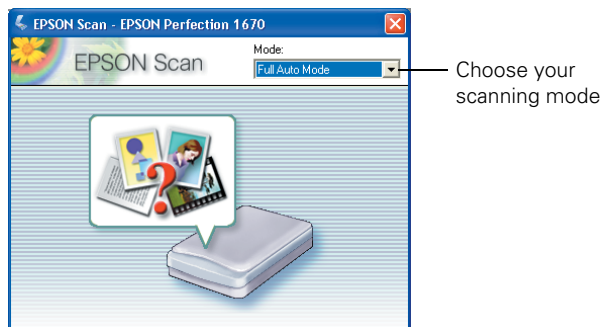

To change settings in Full Auto Mode, click the **Pause** button, then click **Options**. If you're using Home or Professional Mode, the options window automatically appears; select the settings you want to use for your scan.



The selected mode and settings remain in effect until they are changed again.

For more information, see the on-screen *Reference Guide*.

## Restoring Color in Photos

If you have faded photos or negatives, you can use the Color Restoration setting in your software to improve the color of your scan. You can select this setting in Smart Panel or in EPSON Scan.

### Smart Panel

To select the Color Restoration setting, open Smart Panel and select  **RePrint Photo**. You see the screen below. Click the Color Restoration icon.



### EPSON Scan

Color Restoration is available in Home and Professional Modes.

To select Color Restoration, start EPSON Scan. You see a screen similar to this:

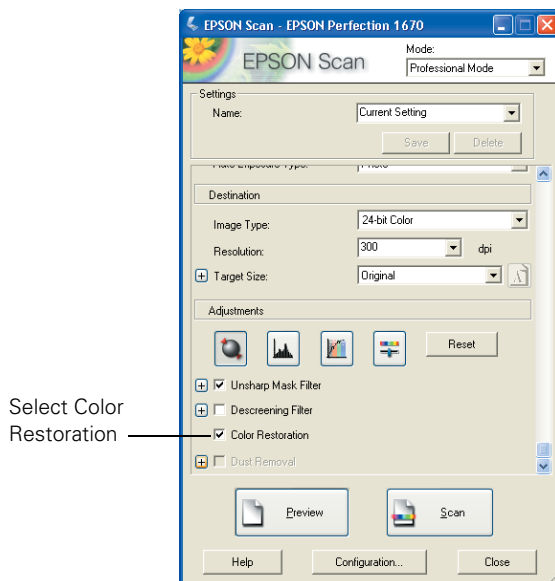

Click the **Preview** button at the bottom of the screen. Then select the **Color Restoration** checkbox. (If you're using Professional Mode, you may need to scroll to the bottom of the screen.)

## Placing Film on the Scanner

The scanner cover has a built-in transparency unit. To scan negative film or slides, you need to remove the reflective document mat from the cover and place the film in a holder on the scanner glass.

1. Make sure the transparency unit cable is connected to the back of the scanner.

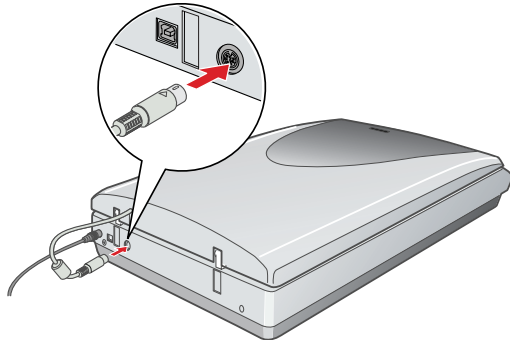

2. Lift the scanner cover all the way up and slide the reflective document mat up and off the scanner cover.

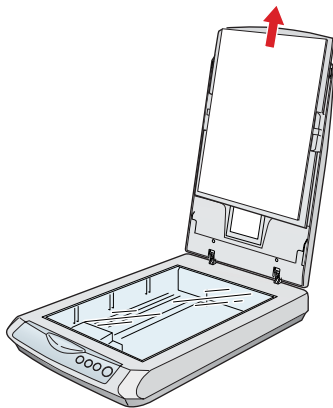

3. Slide the negative strip into the film holder with the film's shiny base side facing down.

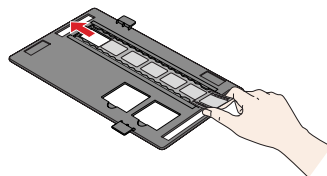

4. Place the film holder in the correct position for your film type. If you are scanning slides, place the holder on the scanner first, then place the slides in the holder.

Be sure to match the letter on the film holder tab with the corresponding letter on the scanner.

**A**

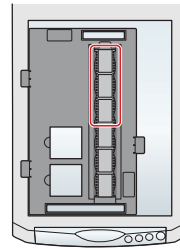

**Negatives:**

(A) If you are scanning the first 3 frames of the negative strip, place the film holder against the left edge of the scanner.

**B**

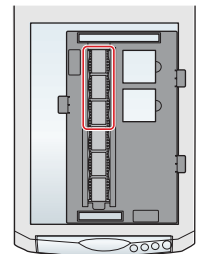

(B) For the last 3 frames, rotate the position of the film holder and place it against the right edge of the scanner.

**C**

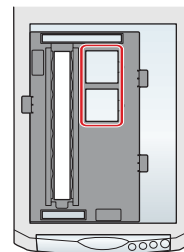

**Slides (C)**

Place the holder on the scanner glass, then put the slides in the holder.



Make sure the narrow calibration window at the top of the film holder is clean and uncovered to ensure an accurate scan.

5. Close the scanner cover.



Make sure there is no dust on the slides or negatives. You can select the  Dust Removal Dust Removal setting in EPSON Scan to improve your scan.

If your scanned image is upside down, you can use the Rotate buttons in EPSON Smart Panel (not available in all Smart Panel applications) or in Preview mode in EPSON Scan. You can also rotate the image in most image editing applications.

---

## Transporting the Scanner

---

Before transporting the scanner over a long distance or storing it for an extended period, you need to lock the scanner's carriage to prevent damage. Follow these steps:

1. Plug in the scanner and wait until the carriage moves to the home position (nearest the buttons). When the indicator light remains on (green), unplug the scanner.
2. If the optional interface cable is attached, disconnect it.
3. Slide the transportation lock to the locked position to secure the carriage.

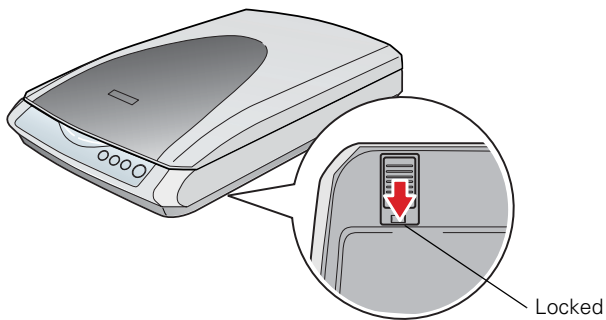

Caution: Do not turn the scanner over; this may damage it.

4. Attach the protective materials and repack it in the original box.

---

## Related Documentation

---

CPD-16153	EPSON Perfection 1670 Photo <i>Start Here</i> poster
CPD-16155	EPSON Perfection 1670 Photo scanner software CD-ROM
CPD-16154	Notices booklet
—	<i>Scanner Reference Guide</i> (HTML)
PL-PERF1670P	EPSON Perfection 1670 Photo Parts Price List